



Customer		
Customer Address	Delivery Address (if different)	Page _____ of _____
		Goods
		VAT
		Total
Contact	Delivery Method	Order Date
Tel	Despatch Route	Delivery Date
Fax	Customer Ref	
Email	Sales Contact	

OUTSIDE VIEW ONLY **LIST CODE**

OUTER FRAME

SPD702 62mm

SPD701 78mm

EXTERNAL COLOUR

Door _____

Frame _____

INTERNAL COLOUR

Door _____

Frame _____

WEATHER BAR

White Silver

Black Match

THRESHOLD

Low SPD 703

→ Full width

→ Std width

Outer Frame

ITEM DETAILS

Item	Qty

Location _____

Door Type _____

All doors open in.

CILL

None

150mm (ETC457)

190mm (ETC458)

225mm (ETC479)

Use SPD750 infill with a cill.

ADD-ON - 20mm

Head

Locking Jamb

Hinge Jamb

Add on recommended down hinge side of SPD702 Outer as there is only 10mm clearance on the hinge

LOCK

ACPD681 10 Point Lock

ACPD670 Slam lock

Cylinder

Colour

→ S/Steel

→ Chrome

Type

→ Thumbturn In/Key Out

→ Key Both Sides

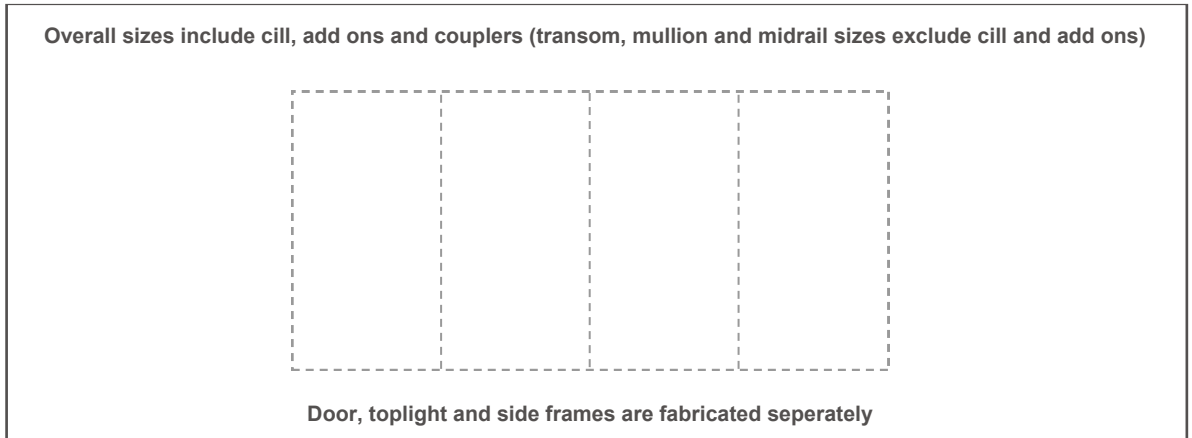

LETTERPLATE

Yes Brushed silver as std

EXTRA HARDWARE

.....

.....

.....

.....

.....

NOTES

For installation guidance please visit:
<https://www.smartsystems.co.uk/installdesignerdoos>

SIDE PANELS + TOPLIGHT

ETC304 70mm Square Outer

Ext. glazed - Square Bead

ETC357 - 25mm Coupler

(Deduct from side frames/toplight)

GLAZING

Planitherm total+ Argon, Toughened

Door

- Triple Glazed

- Diff. Lami (middle pane)

Side panel / Toplight

(Double glazed and clear as std)

- Triple Glazed

- Diff. Lami (middle pane if triple)

- Satin (middle pane if triple)

- Unglazed

INTERNAL HANDLE

None

As Below

.....

EXTERNAL HANDLE

None

As Below

.....

HINGE COLOUR

Black

White

To Match Door

To Match Frame

Note to sales, please check compatibility of sizes / lock / outer on Door Designer before completing survey - especially with SPD701.

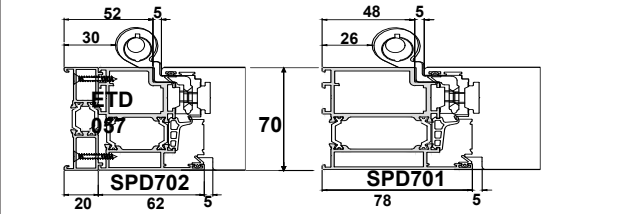

TERMS AND CONDITIONS

Designer Doors are inspected and photographed before being packaged. The packaging has a 'shock dot' - if a colour is visible, do not accept delivery and notify your sales contact immediately. The door MUST be inspected on or as soon after delivery as possible. Any damage must be reported to your sales contact within 36 hours of delivery, accompanied by photographic/video evidence. If there is any damage, do not install the door.

Once the order has been placed, alterations will not be possible. Please check the order requirements carefully.